

SCG-C Series Expansion Joint
 Sizes 200 through 1200
 (Slab-to-Wall)



50 MM WAY
 PENDERGRASS, GA. 30567
 706-824-7500 PHONE

www.mm.systems

For Spec-Data, Install Guides, and other data visit www.mm.systems

RIGHTS OF DESIGN

All rights of design, detail, engineering and/or invention contained herein are the property of MM Systems and hereby reserved and are not to be reproduced or provided to any other party. MM Systems reserves the right to amend or withdraw any information contained herein without notice and will not be liable for any inaccuracy or ambiguity of said information.

Split Slab Membrane Cover Plate Gutter System

SCG-C Series (200-1200)

| | | |
|------------------|---------------------------|--|
| Drawn by: LRM | Scale: NTS | Drawing Number: 41275-02 |
| SHT. 1 OF 3 | Issue Date: 07/15/2025 | |

SCG-C SERIES EXPANSION JOINT MOVEMENT CHART

| Model Number | Joint Opening (JO ^N) | | Slide Plate Width (SW ^N) | | Thermal Movement (JO ^T) | | | | Seismic Movement (JO ^S) | | | | Total (JO ^A) | |
|--------------|----------------------------------|-----|--------------------------------------|-----|-------------------------------------|----|--------------|-----|-------------------------------------|---|--------------|-----|--------------------------|-----|
| | Nominal | | Nominal | | Minimum | | Maximum | | Minimum | | Maximum | | Movement | |
| | | | | | | | | | | | | | | |
| SCG-C-200 | 2.00 | 51 | 6.00 | 152 | 1.00 | 25 | 4.00 | 102 | 0.25 | 6 | 4.00 | 102 | 3.75 | 95 |
| SCG-C-400 | 4.00 | 102 | 8.00 | 203 | 1.00 | 25 | 6.00 | 152 | 0.25 | 6 | 6.00 | 152 | 5.75 | 146 |
| SCG-C-600 | 6.00 | 152 | 11.00 | 279 | 1.00 | 25 | 9.00 | 229 | 0.25 | 6 | 9.00 | 229 | 8.75 | 222 |
| SCG-C-800 | 8.00 | 203 | 14.00 | 356 | 1.00 | 25 | 12.00 | 305 | 0.25 | 6 | 12.00 | 305 | 11.75 | 298 |
| SCG-C-1000 | 10.00 | 254 | 17.00 | 432 | 1.00 | 25 | 15.00 | 381 | 0.25 | 6 | 15.00 | 381 | 14.75 | 375 |
| SCG-C-1200 | 12.00 | 304 | 20.00 | 508 | 1.00 | 25 | 18.00 | 457 | 0.25 | 6 | 18.00 | 457 | 17.75 | 451 |

Dimension shown in **inches** (bold) and millimeters. Refer to the SCG AutoCAD file for individual system drawings.

LOAD TABLE

| | |
|---|----------------------|
|  | Safe Walking Surface |
|  | ADA Compliant |
|  | Extreme Weather |
|  | Shopping Cart |

Note: The SCG-C loading capabilities shown above are based upon average equipment weights, wheel types and sizes. For project-specific loading capabilities, contact MM Systems with technical data related to wheel type, contact area (footprint), distributed load per wheel, and speed of traffic.

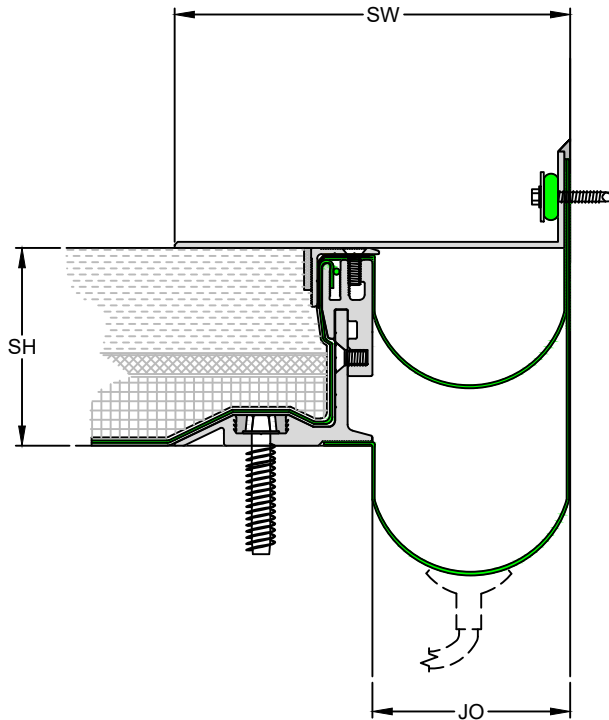

| Base Angle | System | |
|------------|-------------|-----|
| Size | Height (SH) | |
| 4 x 2 | 3.25 | 83 |
| 4 x 2.25 | 3.5 | 89 |
| 4 x 2.5 | 3.75 | 95 |
| 4 x 2.75 | 4 | 102 |
| 4 x 3 | 4.25 | 108 |
| 4 x 3.25 | 4.5 | 114 |
| 4 x 3.5 | 4.75 | 121 |
| 4 x 3.75 | 5 | 127 |
| 4 x 4 | 5.25 | 133 |
| 4 x 4.25 | 5.5 | 140 |
| 4 x 4.5 | 5.75 | 146 |
| 4 x 4.75 | 6 | 152 |



50 MM WAY
PENDERGRASS, GA. 30567
706-824-7500 PHONE

www.mm.systems

For Spec-Data, Install Guides, and other data visit www.mm.systems

RIGHTS OF DESIGN

All rights of design, detail, engineering and/or invention contained herein are the property of MM Systems and hereby reserved and are not to be reproduced or provided to any other party. MM Systems reserves the right to amend or withdraw any information contained herein without notice and will not be liable for any inaccuracy or ambiguity of said information.

Split Slab Membrane Cover Plate Gutter System

SCG-C Series (200-1200)

Drawn by:

LRM

Scale:

NTS

Drawing Number:

SHT. 2 OF 3

Issue Date:
07/15/2025

41275-02

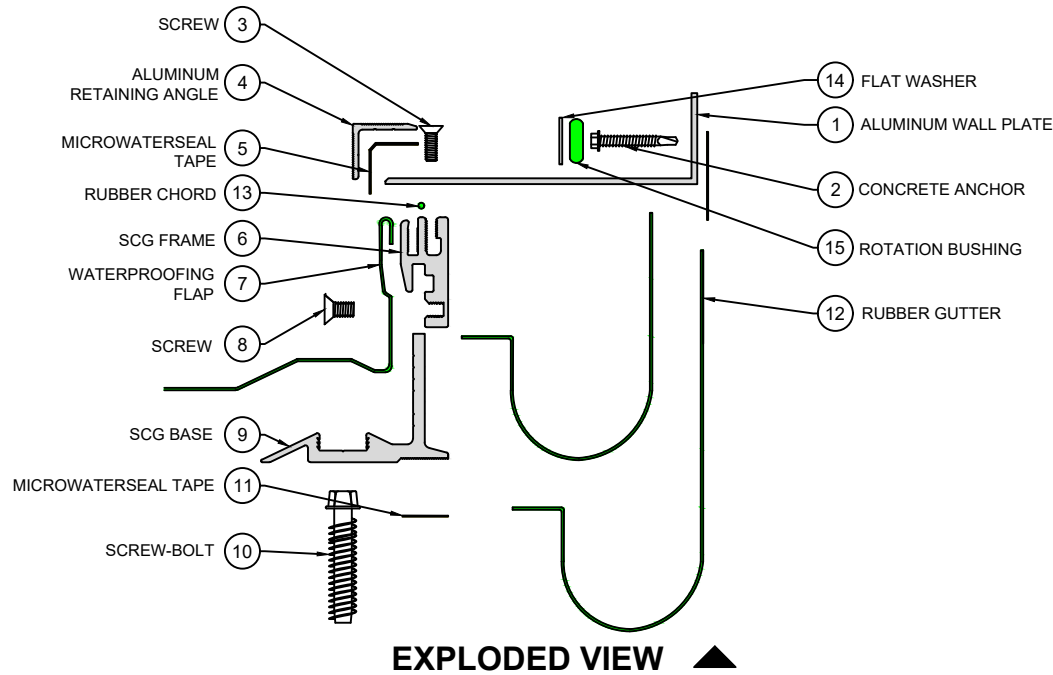

EXPLODED VIEW ▲

PART NUMBERS ▼

| Locator | Part Component | SCG-C-200 | SCG-C-400 | SCG-C-600 | SCG-C-800 | SCG-C-1000 | SCG-C-1200 |
|---------|--------------------------|-----------------------|-----------------------|-----------------------|-----------------------|-----------------------|-----------------------|
| 1 | Aluminum Wall Plate | WAAA-AM-10-0600-00-18 | WAAA-AM-10-0800-00-18 | WAAB-AM-10-1100-00-18 | WAAB-AM-10-1400-00-18 | WAAB-AM-10-1700-00-18 | WAAC-AM-10-2000-00-18 |
| 2 | Concrete Anchor | 9402 | 9402 | 9402 | 9402 | 9402 | 9402 |
| 3 | Screw | 9382 | 9382 | 9382 | 9382 | 9382 | 9382 |
| 4 | Aluminum Retaining Angle | 7025-M-10 | 7025-M-10 | 7025-M-10 | 7025-M-10 | 7025-M-10 | 7025-M-10 |
| 5 | Microwaterseal Tape | Microwaterseal30X2 | Microwaterseal30X2 | Microwaterseal30X2 | Microwaterseal30X2 | Microwaterseal30X2 | Microwaterseal30X2 |
| 6 | SCG Frame | 8346 | 8346 | 8346 | 8346 | 8346 | 8346 |
| 7 | Waterproofing Flap | 9118-12 | 9118-12 | 9118-12 | 9118-18 | 9118-18 | 9118-18 |
| 8 | Screw | 9348 | 9348 | 9348 | 9348 | 9348 | 9348 |
| 9 | SSM Base | See Base Frame Chart | See Base Frame Chart | See Base Frame Chart | See Base Frame Chart | See Base Frame Chart | See Base Frame Chart |
| 10 | Screw-Bolt | 7420 | 7420 | 7420 | 7420 | 7420 | 7420 |
| 11 | Microwaterseal Tape | Microwaterseal60X1 | Microwaterseal60X1 | Microwaterseal60X1 | Microwaterseal60X1 | Microwaterseal60X1 | Microwaterseal60X1 |
| 12 | Rubber Gutter | 9109-12 | 9109-12 | 9109-12 | 9109-18 | 9109-18 | 9109-18 |
| 13 | Rubber Chord | 9457 | 9457 | 9457 | 9457 | 9457 | 9457 |
| 14 | Flat Washer | 8312-1/4 | 8312-1/4 | 8312-1/4 | 8312-1/4 | 8312-1/4 | 8312-1/4 |
| 15 | Rotation Bushing | 9455 | 9455 | 9455 | 9455 | 9455 | 9455 |

| System Height | Base Frame |
|---------------|------------|
| 3.25" | 7431#0200 |
| 3.50" | 7431#0204 |
| 3.75" | 7431#0208 |
| 4.00" | 7431#0212 |
| 4.25" | 7431#0300 |
| 4.50" | 7431#0304 |
| 4.75" | 7431#0308 |
| 5.00" | 7431#0312 |
| 5.25" | 7431#0400 |
| 5.50" | 7431#0404 |
| 5.75" | 7431#0408 |
| 6.00" | 7431 |



50 MM WAY
PENDERGRASS, GA. 30567
706-824-7500 PHONE

www.mm.systems

For Spec-Data, Install Guides, and other data visit www.mm.systems

RIGHTS OF DESIGN

All rights of design, detail, engineering and/or invention contained herein are the property of MM Systems and hereby reserved and are not to be reproduced or provided to any other party. MM Systems reserves the right to amend or withdraw any information contained herein without notice and will not be liable for any inaccuracy or ambiguity of said information.

Split Slab Membrane Cover Plate Gutter System

SCG-C Series (200-1200)

| | | |
|------------------|---------------------------|--|
| Drawn by: LRM | Scale: NTS | Drawing Number: 41275-02 |
| SHT. 3 OF 3 | Issue Date: 07/15/2025 | |