

SSM-C Series Expansion Joint
Sizes 250 through 550
 (Slab-to-Wall)



50 MM WAY
 PENDERGRASS, GA. 30567
 706-824-7500 PHONE

www.mm.systems

For Spec-Data, Install Guides, and other data visit www.mm.systems

RIGHTS OF DESIGN

All rights of design, detail, engineering and/or invention contained herein are the property of MM Systems and hereby reserved and are not to be reproduced or provided to any other party. MM Systems reserves the right to amend or withdraw any information contained herein without notice and will not be liable for any inaccuracy or ambiguity of said information.

Split Slab Membrane System

SSM-C Series (250-550)





Drawn by:	Scale:	Drawing Number:
LRM	NTS	
SHT. 1 OF 3	Issue Date:	
	02/12/2025	41200-02

SSM-C SERIES EXPANSION JOINT MOVEMENT CHART

Model Number	Joint Opening (JO ^N)		Sight Line (SL ^N)		Thermal Movement (JO ^T)				Seismic Movement (JO ^S)				Total (JO ^A)	
	Nominal		Nominal		Minimum		Maximum		Minimum		Maximum		Movement	
SSM-C-250	1.50	38	2.75	70	0.75	19	2.50	64	0.75	19	3.25	83	2.50	64
SSM-C-350	2.00	51	3.25	83	1.00	25	3.50	89	1.00	25	4.25	108	3.25	83
SSM-C-450	3.00	76	4.25	108	1.50	38	4.50	114	1.50	38	5.50	140	4.00	102
SSM-C-550	4.00	102	5.25	133	1.50	38	5.50	140	1.50	38	6.50	165	5.00	127

Dimension shown in **inches** (bold) and millimeters. Refer to the SSM AutoCAD file for individual system drawings.

LOAD TABLE

	Safe Walking Surface
	Auto (Low Speed)
	Maintenance Cart
	Passenger Cart
	Rain Resistant

Note: The SSM-C loading capabilities shown above are based upon average vehicular and equipment weights, wheel types and sizes. For project-specific loading capabilities, contact MM Systems with technical data related to wheel type, contact area (footprint), distributed load per wheel, and speed of traffic.

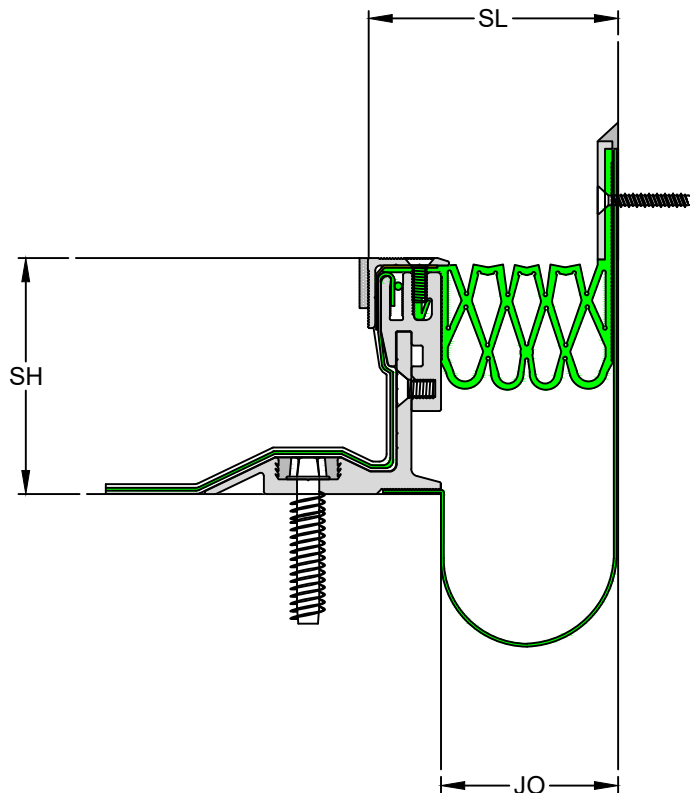

Base Angle	System	
Size	Height (SH)	
4 x 1.75	See Pg. 2	
4 x 2	3.25	83
4 x 2.25	3.5	89
4 x 2.5	3.75	95
4 x 2.75	4	102
4 x 3	4.25	108
4 x 3.25	4.5	114
4 x 3.5	4.75	121
4 x 3.75	5	127
4 x 4	5.25	133
4 x 4.25	5.5	140
4 x 4.5	5.75	146
4 x 4.75	6	152



50 MM WAY
PENDERGRASS, GA. 30567
706-824-7500 PHONE

www.mm.systems

For Spec-Data, Install Guides, and other data visit www.mm.systems

RIGHTS OF DESIGN

All rights of design, detail, engineering and/or invention contained herein are the property of MM Systems and hereby reserved and are not to be reproduced or provided to any other party. MM Systems reserves the right to amend or withdraw any information contained herein without notice and will not be liable for any inaccuracy or ambiguity of said information.

Split Slab Membrane System

SSM-C Series (250-550)

Drawn by:
LRM

SHT. 2 OF 3

Scale:
NTS

Issue Date:
02/12/2025

Drawing Number:

41200-02

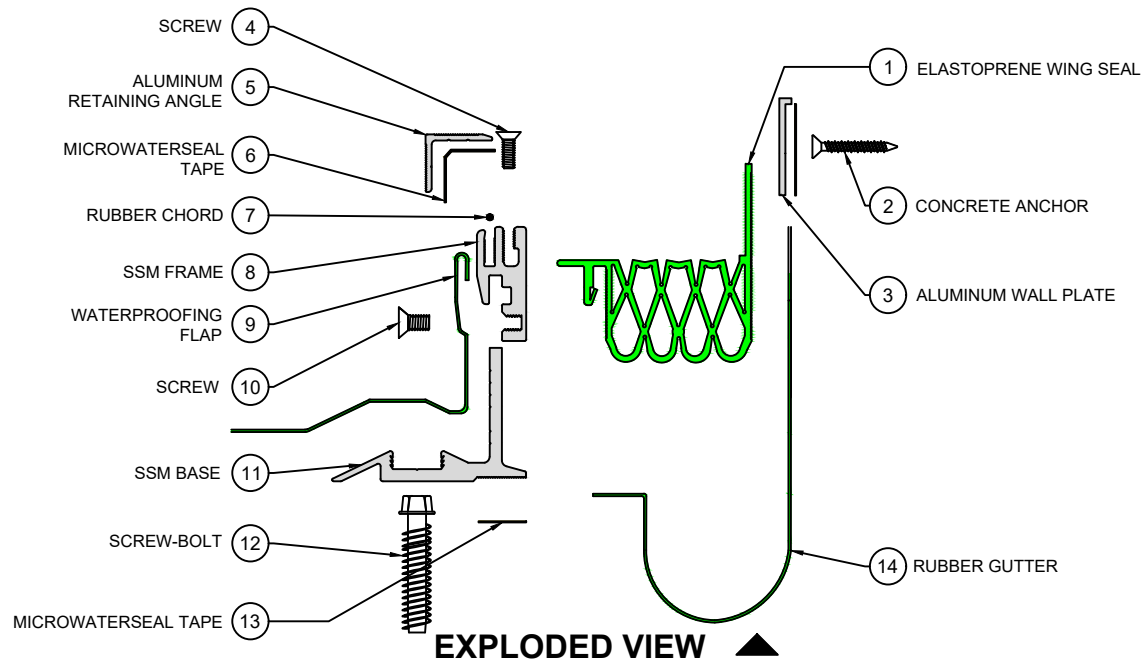

PART NUMBERS

Locator	Part Component	SSM-C-250	SSM-C-350	SSM-C-450	SSM-C-550
1	Elastoprene Wing Seal	8389-65	8390-65	8391-65	8392-65
2	Concrete Anchor	9377	9377	9377	9377
3	Aluminum Wall Plate	8453	8453	8453	8453
4	Screw	9382	9382	9382	9382
5	Aluminum Retaining Angle	7025-M-10	7025-M-10	7025-M-10	7025-M-10
6	Microwaterseal Tape	Microwaterseal30X2	Microwaterseal30X2	Microwaterseal30X2	Microwaterseal30X2
7	Rubber Chord	9457	9457	9457	9457
8	SSM Frame	8346	8346	8346	8346
9	Waterproofing Flap	9118-12	9118-12	9118-12	9118-12
10	Screw	9348	9348	9348	9348
11	SSM Base	See Base Frame Chart	See Base Frame Chart	See Base Frame Chart	See Base Frame Chart
12	Screw-Bolt	7420	7420	7420	7420
13	Microwaterseal Tape	Microwaterseal60X1	Microwaterseal60X1	Microwaterseal60X1	Microwaterseal60X1
14	Rubber Gutter	9109-12	9109-12	9109-18	9109-18

System Height	Base Frame
3.25"	7431 #0200
3.50"	7431 #0204
3.75"	7431 #0208
4.00"	7431 #0212
4.25"	7431 #0300
4.50"	7431 #0304
4.75"	7431 #0308
5.00"	7431 #0312
5.25"	7431 #0400
5.50"	7431 #0404
5.75"	7431 #0408
6.00"	7431



50 MM WAY
PENDERGRASS, GA. 30567
706-824-7500 PHONE

www.mm.systems

For Spec-Data, Install Guides, and other data visit www.mm.systems

RIGHTS OF DESIGN

All rights of design, detail, engineering and/or invention contained herein are the property of MM Systems and hereby reserved and are not to be reproduced or provided to any other party. MM Systems reserves the right to amend or withdraw any information contained herein without notice and will not be liable for any inaccuracy or ambiguity of said information.

Split Slab Membrane Series

SSM-C Series (250-550)

Drawn by:

LRM

Scale:

NTS

Drawing Number:

SHT. 3 OF 3

Issue Date:
02/12/2025

41200-02