

SMP Series Expansion Joint

Series 1400 through 2400

(Slab-to-Slab)



50 MM WAY
PENDERGRASS, GA. 30567
706-824-7500 PHONE

www.mm.systems

For Spec-Data, Install Guides, and other data visit www.mm.systems

RIGHTS OF DESIGN

All rights of design, detail, engineering and/or invention contained herein are the property of MM Systems and hereby reserved and are not to be reproduced or provided to any other party. MM Systems reserves the right to amend or withdraw any information contained herein without notice and will not be liable for any inaccuracy or ambiguity of said information.

Surface Mount Seismic Cover Expansion Joint

SMP Series (1400-2400)/50% Movement

Drawn by:

LRM

Scale:

NTS

Drawing Number:

SHT. 1 OF 3

Issue Date:
06/10/2025





31200-02

SMP SERIES EXPANSION JOINT MOVEMENT CHART (1400-2400)

Model Number	Joint Opening (JO ^N)		Sight Line (SL ^N)		Thermal Movement (JO ^T)				Seismic Movement (JO ^S)				Total (JO ^A)		Slide Plate		Slide Plate Width	
	Nominal		Nominal		Minimum		Maximum		Minimum		Maximum		Movement		Thickness (ST)		(SW)	
SMP-1400	14.00	356	33.10	841	12.00	305	16.00	406	2.00	51	21.00	533	18.25	464	0.250	6	25.00	635
SMP-1600	16.00	406	35.10	892	14.00	356	18.00	457	2.00	51	24.00	610	21.25	540	0.250	6	28.00	711
SMP-1800	18.00	457	37.10	942	16.00	406	20.00	508	2.00	51	27.00	686	24.25	616	0.375	10	29.50	749
SMP-2000	20.00	508	39.10	993	18.00	457	22.00	559	2.00	51	30.00	762	27.25	692	0.375	10	31.00	787
SMP-2200	22.00	559	41.10	1044	20.00	508	24.00	610	2.00	51	33.00	838	30.25	768	0.375	10	34.00	864
SMP-2400	24.00	610	43.10	1095	22.00	559	26.00	660	2.00	51	36.00	914	33.25	845	0.375	10	37.00	940

Dimension shown in **inches** (bold) and millimeters. Refer to the SMP AutoCAD file for individual system drawings.

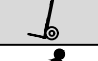
LOAD TABLE

	Passenger Cart
	Maintenance Cart
	Hand Truck
	Safe Walking Surface
	ADA Compliant

Note: The SMP loading capabilities shown above are based upon average vehicular and equipment weights, wheel types and sizes. For project-specific loading capabilities, contact MM Systems with technical data related to wheel type, contact area (footprint), distributed load per wheel, and speed of traffic.

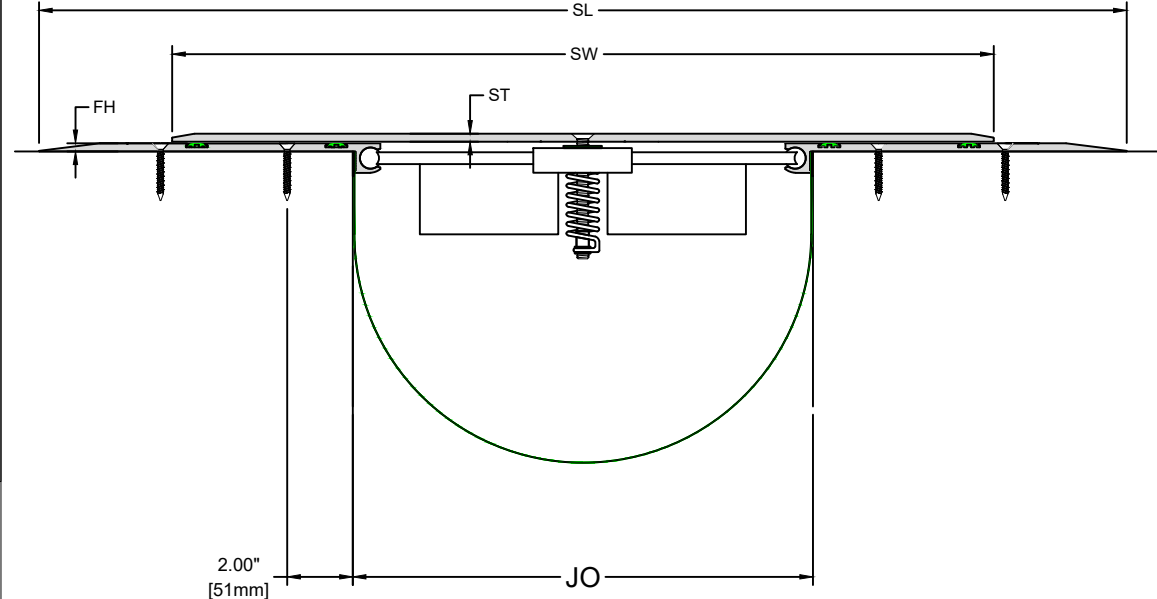

RIGHTS OF DESIGN

All rights of design, detail, engineering and/or invention contained herein are the property of MM Systems and hereby reserved and are not to be reproduced or provided to any other party. MM Systems reserves the right to amend or withdraw any information contained herein without notice and will not be liable for any inaccuracy or ambiguity of said information.

Surface Mount Seismic Cover Expansion Joint

SMP Series (1400-2400)/50% Movement

Drawn by: JPS	Scale: NTS	Drawing Number:
SHT. 2 OF 3	Issue Date: 09/06/2022	31200-02



50 MM WAY
PENDERGRASS, GA. 30567
706-824-7500 PHONE

www.mm.systems

For Spec-Data, Install Guides, and other data visit www.mm.systems

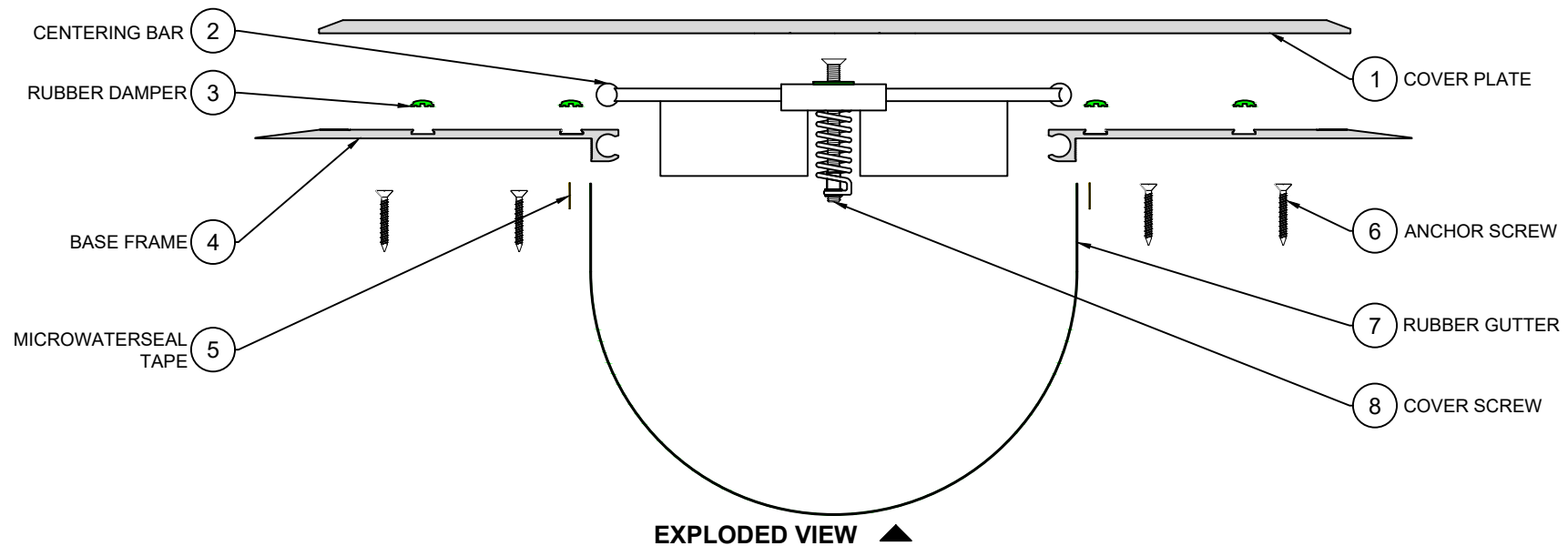

PART NUMBERS ▼

Locator	Part Component	SMP-1400	SMP-1600	SMP-1800	SMP-2000	SMP-2200	SMP-2400
1	Cover Plate	CPEC-AT-10-2500-00-24	CPEC-AT-10-2800-02-18	CPEC-AT-05-2908-02-12	CPEC-AT-05-3100-02-12	CPEC-AT-05-3400-02-12	CPEC-AT-05-3700-02-12
2	Centering Bar	ASSY-SCD-2400-S001-v2	ASSY-SCD-2600-S001-v2	ASSY-SCD-2800-S001-v2	ASSY-SCD-3300-S001-v2	ASSY-SCD-3600-S001-v2	ASSY-SCD-4100-S001-v2
3	Rubber Damper	8461-65	8461-65	8461-65	8461-65	8461-65	8461-65
4	Base Frame	ASSY-71397143-M-10-00-18	ASSY-71397143-M-10-00-18	ASSY-71387143-M-10-00-18	ASSY-71387143-M-10-00-18	ASSY-71387143-M-10-00-18	ASSY-71387143-M-10-00-18
5	Microwaterseal Tape	Microwaterseal60X3/4	Microwaterseal60X3/4	Microwaterseal60X3/4	Microwaterseal60X3/4	Microwaterseal60X3/4	Microwaterseal60X3/4
6	Anchor Screw	9377	9377	9377	9377	9377	9377
7	Rubber Gutter	9109-30	9109-30	9109-35	9109-35	9109-40	9109-40
8	Cover Screw	8325	8325	8325	8325	8325	8325



50 MM WAY
PENDERGRASS, GA. 30567
706-824-7500 PHONE

www.mm.systems

For Spec-Data, Install Guides, and other data visit www.mm.systems

RIGHTS OF DESIGN

All rights of design, detail, engineering and/or invention contained herein are the property of MM Systems and hereby reserved and are not to be reproduced or provided to any other party. MM Systems reserves the right to amend or withdraw any information contained herein without notice and will not be liable for any inaccuracy or ambiguity of said information.

Surface Mount Seismic Cover Expansion Joint

SMP Series (1400-2400)/50% Movement

Drawn by: LRM	Scale: NTS	Drawing Number:
SHT. 3 OF 3	Issue Date: 06/10/2025	31200-02