

**EIS-Plus Series Expansion Joint
Sizes 200 through 400
(Slab-to-Slab)**

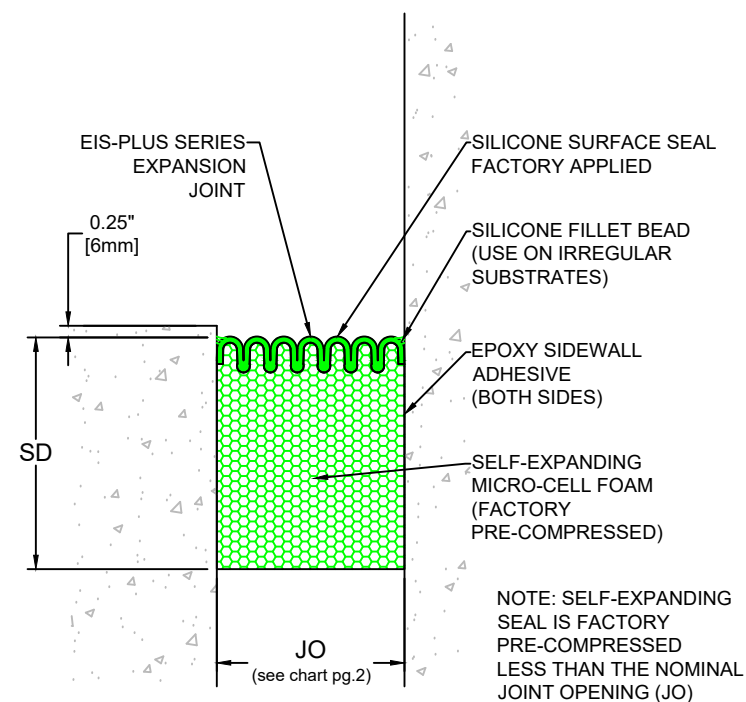

**EIS-Plus Series Expansion Joint
Sizes 200 through 400
(Slab-to-Wall)**



50 MM WAY
PENDERGRASS, GA. 30567
706-824-7500 PHONE

www.mm.systems

For Spec-Data, Install Guides, and other data visit www.mm.systems

RIGHTS OF DESIGN

All rights of design, detail, engineering and/or invention contained herein are the property of MM Systems and hereby reserved and are not to be reproduced or provided to any other party. MM Systems reserves the right to amend or withdraw any information contained herein without notice and will not be liable for any inaccuracy or ambiguity of said information.

Expanding Impregnated Seal Expansion Joint EIS-Plus Series (200-400)

Drawn by:
BDM

SHT. 1 OF 2

Scale:
NTS

Issue Date:
12/20/2023

Drawing Number:

31651-01

EIS-PLUS SERIES EXPANSION JOINT MOVEMENT CHART

Model Number	Joint Opening (JO ^N)		Sight Line (SL ^N)		Thermal / Seismic Movement (JO ^T)				Total (JO ^A)		Lateral		Vertical		Seal Depth (SD)	
	Nominal		Nominal		Minimum		Maximum		Movement		Shear		Displacement			
EIS-200+	2.00	51	2.00	51	1.000	25	3.000	76	2.00	51	2.00	51	2.00	51	3.00	76
EIS-225+	2.25	57	2.25	57	1.125	29	3.375	86	2.25	57	2.25	57	2.25	57	3.00	76
EIS-250+	2.50	64	2.50	64	1.250	32	3.750	95	2.50	64	2.50	64	2.50	64	3.00	76
EIS-275+	2.75	70	2.75	70	1.375	35	4.125	105	2.75	70	2.75	70	2.75	70	3.00	76
EIS-300+	3.00	76	3.00	76	1.500	38	4.500	114	3.00	76	3.00	76	3.00	76	3.00	76
EIS-325+	3.25	83	3.25	83	1.625	41	4.875	124	3.25	83	3.25	83	3.25	83	3.00	76
EIS-350+	3.50	89	3.50	89	1.750	44	5.250	133	3.50	89	3.50	89	3.50	89	3.00	76
EIS-375+	3.75	95	3.75	95	1.875	48	5.625	143	3.75	95	3.75	95	3.75	95	3.00	76
EIS-400+	4.00	102	4.00	102	2.000	51	6.000	152	4.00	102	4.00	102	4.00	102	4.00	102

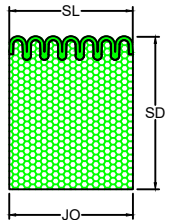

SINGLE SIDE
SILICONE

Dimension shown in **inches** (bold) and millimeters. Contact MM Systems for larger system sizes.

Cover plates are available as an option to protect the foam seals but are not mandatory.

Refer to the EIS-Plus AutoCAD file for individual seal drawings.



MM[®]
SYSTEMS

50 MM WAY
PENDERGRASS, GA. 30567
706-824-7500 PHONE

www.mm.systems

For Spec-Data, Install Guides, and other data visit www.mm.systems

RIGHTS OF DESIGN

All rights of design, detail, engineering and/or invention contained herein are the property of MM Systems and hereby reserved and are not to be reproduced or provided to any other party. MM Systems reserves the right to amend or withdraw any information contained herein without notice and will not be liable for any inaccuracy or ambiguity of said information.

Expanding Impregnated Seal Expansion Joint EIS-Plus Series (200-400)

Drawn by: BDM	Scale: NTS	Drawing Number: 31651-01
SHT. 2 OF 2	Issue Date: 12/20/2023	