

NOTE: SELF-EXPANDING  
SEAL IS FACTORY  
PRE-COMPRESSED  
LESS THAN THE NOMINAL  
JOINT OPENING (JO)

SINGLE SIDE SILICONE  
SURFACE SEAL  
FACTORY APPLIED

CHAMFER EDGE OF  
CONCRETE

SILICONE FILLET BEAD  
(USE ON IRREGULAR  
SUBSTRATES)

INTEGRAL SMOKE  
SHIELD

EPOXY SIDEWALL  
ADHESIVE  
(BOTH SIDES)

SELF-EXPANDING FIRE  
RATED MICRO-CELL  
FOAM (FACTORY  
PRE-COMPRESSED)

EIS-FR-2S SERIES  
2 HOUR FIRE RATED  
EXPANSION JOINT

0.25"  
[6mm]

SD

JO

(see chart pg.3)

#### IMPORTANT LIFE SAFETY PRODUCT NOTE



LISTING DESIGN  
(see page 3 chart)

2-HOUR FOAM SEAL FIRE BARRIER MUST BE INSTALLED IN A PROPERLY CONSTRUCTED 2-HOUR ENDURANCE RATED CONCRETE SLAB WITH AN OVERALL THICKNESS THAT COMPLIES WITH IBC TABLE 721.2.2.1 FOR "MINIMUM SLAB THICKNESS", BUT NOT LESS THAN 4.5-INCHES AT THE VERTICAL FACE OF THE JOINT OPENING. BARRIERS MUST BE INSTALLED IN STRICT ACCORDANCE WITH MM SYSTEMS PRODUCT INSTALLATION INSTRUCTIONS. CONTRACTOR MUST VERIFY PRIOR TO FABRICATION.

#### EIS-FR-2S

**2 Hour Fire Rated Series Expansion Joint  
Slab-to-Slab (Single Side Silicone)**

EIS-FR-2S SERIES  
2 HOUR FIRE RATED  
EXPANSION JOINT

0.25"  
[6mm]

SD

JO

(see chart pg.3)

SINGLE SIDE SILICONE  
SURFACE SEAL  
FACTORY APPLIED

SILICONE FILLET BEAD  
(USE ON IRREGULAR  
SUBSTRATES)

EPOXY SIDEWALL  
ADHESIVE  
(BOTH SIDES)

INTEGRAL SMOKE  
SHIELD

SELF-EXPANDING FIRE  
RATED MICRO-CELL  
FOAM (FACTORY  
PRE-COMPRESSED)

NOTE: SELF-EXPANDING  
SEAL IS FACTORY  
PRE-COMPRESSED  
LESS THAN THE NOMINAL  
JOINT OPENING (JO)

#### IMPORTANT LIFE SAFETY PRODUCT NOTE



LISTING DESIGN  
(see page 3 chart)

2-HOUR FOAM SEAL FIRE BARRIER MUST BE INSTALLED IN A PROPERLY CONSTRUCTED 2-HOUR ENDURANCE RATED CONCRETE SLAB WITH AN OVERALL THICKNESS THAT COMPLIES WITH IBC TABLE 721.2.2.1 FOR "MINIMUM SLAB THICKNESS", BUT NOT LESS THAN 4.5-INCHES AT THE VERTICAL FACE OF THE JOINT OPENING. BARRIERS MUST BE INSTALLED IN STRICT ACCORDANCE WITH MM SYSTEMS PRODUCT INSTALLATION INSTRUCTIONS. CONTRACTOR MUST VERIFY PRIOR TO FABRICATION.

#### EIS-FR-2S

**2 Hour Fire Rated Series Expansion Joint  
Slab-to-Wall (Single Side Silicone)**



50 MM WAY  
PENDERGRASS, GA. 30567  
706-824-7500 PHONE

[www.mm.systems](http://www.mm.systems)

For Spec-Data, Install Guides, and other data visit [www.mm.systems](http://www.mm.systems)

#### RIGHTS OF DESIGN

All rights of design, detail, engineering and/or invention contained herein are the property of MM Systems and hereby reserved and are not to be reproduced or provided to any other party. MM Systems reserves the right to amend or withdraw any information contained herein without notice and will not be liable for any inaccuracy or ambiguity of said information.

#### Expanding Impregnated Seal - 2 Hour Fire Rated Expansion Joint

### EIS-FR-2S Series (050-400)

Drawn by:

LRM

Scale:

NTS

Drawing Number:

SHT. 1 OF 3

Issue Date:

01/07/2025

31652-01

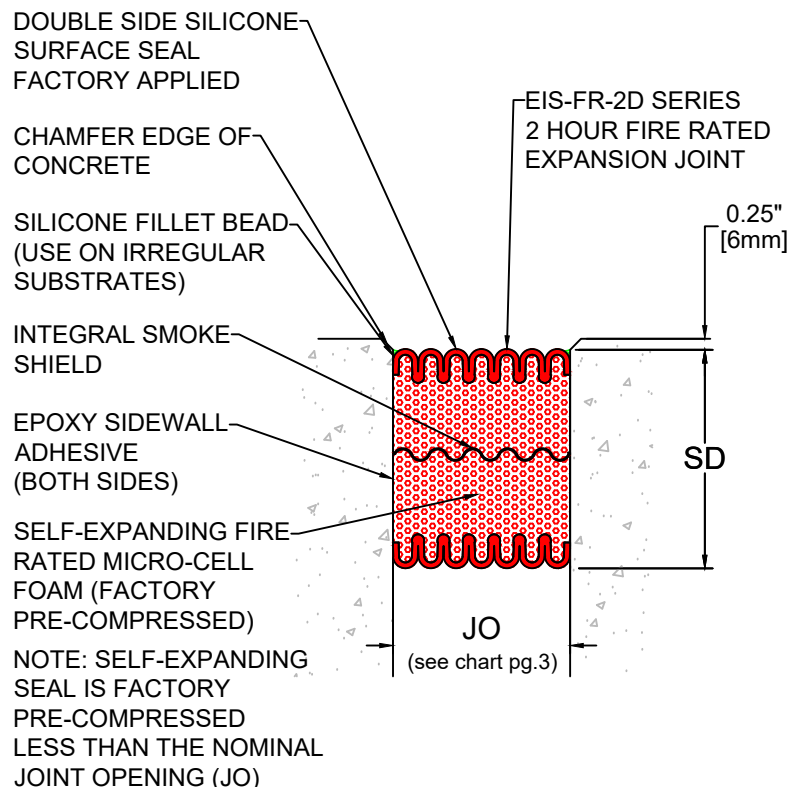

#### IMPORTANT LIFE SAFETY PRODUCT NOTE



LISTING DESIGN  
(see page 3 chart)

2-HOUR FOAM SEAL FIRE BARRIER MUST BE INSTALLED IN A PROPERLY CONSTRUCTED 2-HOUR ENDURANCE RATED CONCRETE SLAB WITH AN OVERALL THICKNESS THAT COMPLIES WITH IBC TABLE 721.2.2.1 FOR "MINIMUM SLAB THICKNESS", BUT NOT LESS THAN 4.5-INCHES AT THE VERTICAL FACE OF THE JOINT OPENING. BARRIERS MUST BE INSTALLED IN STRICT ACCORDANCE WITH MM SYSTEMS PRODUCT INSTALLATION INSTRUCTIONS. CONTRACTOR MUST VERIFY PRIOR TO FABRICATION.

#### EIS-FR-2D

### 2 Hour Fire Rated Series Expansion Joint Slab-to-Slab (Double Side Silicone)

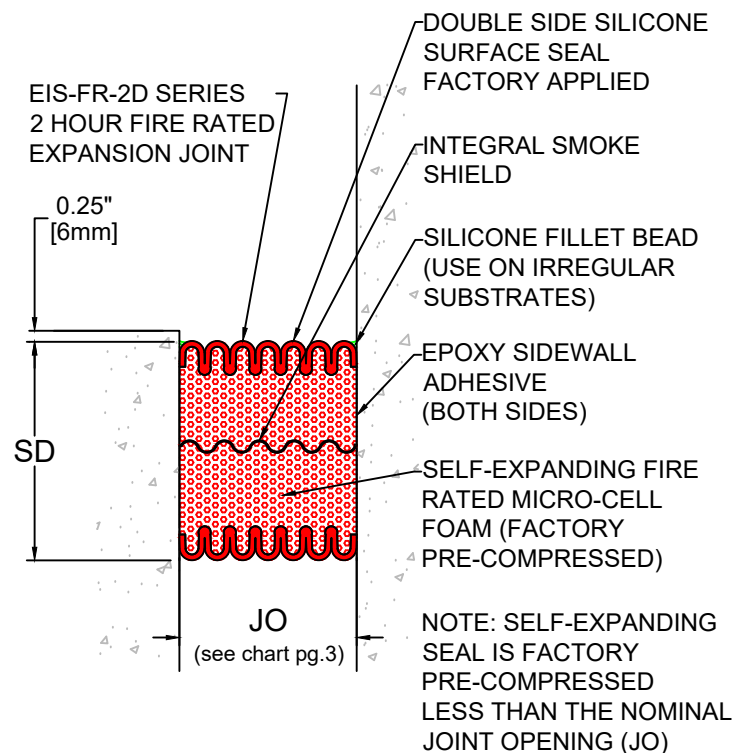

#### IMPORTANT LIFE SAFETY PRODUCT NOTE



LISTING DESIGN  
(see page 3 chart)

2-HOUR FOAM SEAL FIRE BARRIER MUST BE INSTALLED IN A PROPERLY CONSTRUCTED 2-HOUR ENDURANCE RATED CONCRETE SLAB WITH AN OVERALL THICKNESS THAT COMPLIES WITH IBC TABLE 721.2.2.1 FOR "MINIMUM SLAB THICKNESS", BUT NOT LESS THAN 4.5-INCHES AT THE VERTICAL FACE OF THE JOINT OPENING. BARRIERS MUST BE INSTALLED IN STRICT ACCORDANCE WITH MM SYSTEMS PRODUCT INSTALLATION INSTRUCTIONS. CONTRACTOR MUST VERIFY PRIOR TO FABRICATION.

#### EIS-FR-2D

### 2 Hour Fire Rated Series Expansion Joint Slab-to-Wall (Double Side Silicone)



50 MM WAY  
PENDERGRASS, GA. 30567  
706-824-7500 PHONE

[www.mm.systems](http://www.mm.systems)

For Spec-Data, Install Guides, and other data visit [www.mm.systems](http://www.mm.systems)

#### RIGHTS OF DESIGN

All rights of design, detail, engineering and/or invention contained herein are the property of MM Systems and hereby reserved and are not to be reproduced or provided to any other party. MM Systems reserves the right to amend or withdraw any information contained herein without notice and will not be liable for any inaccuracy or ambiguity of said information.

### Expanding Impregnated Seal - 2 Hour Fire Rated Expansion Joint EIS-FR-2D Series (425-500)

Drawn by: LRM	Scale: NTS	Drawing Number:
SHT. 2 OF 3	Issue Date: 01/07/2025	31652-01

## (EIS-FR-2S) FIRE RATED SERIES EXPANSION JOINT MOVEMENT CHART

Model Number	UL Listing	Joint Opening (JO <sup>N</sup> )		Thermal / Seismic Movement (JO <sup>T</sup> )				Total (JO <sup>A</sup> )		Lateral		Vertical		Seal Depth (SD)	
		Nominal		Minimum		Maximum		Movement		Shear		Displacement			
EIS-FR-050-2S	FF-D-0148	<b>0.50</b>	13	<b>0.250</b>	6	<b>0.750</b>	19	<b>0.50</b>	13	<b>0.50</b>	13	<b>0.50</b>	13	<b>4.00</b>	102
EIS-FR-063-2S	FF-D-0148	<b>0.63</b>	16	<b>0.315</b>	8	<b>0.945</b>	24	<b>0.63</b>	16	<b>0.63</b>	16	<b>0.63</b>	16	<b>4.00</b>	102
EIS-FR-075-2S	FF-D-0148	<b>0.75</b>	19	<b>0.375</b>	10	<b>1.125</b>	29	<b>0.75</b>	19	<b>0.75</b>	19	<b>0.75</b>	19	<b>4.00</b>	102
EIS-FR-100-2S	FF-D-0148	<b>1.00</b>	25	<b>0.500</b>	13	<b>1.500</b>	38	<b>1.00</b>	25	<b>1.00</b>	25	<b>1.00</b>	25	<b>4.00</b>	102
EIS-FR-125-2S	FF-D-0148	<b>1.25</b>	32	<b>0.625</b>	16	<b>1.875</b>	48	<b>1.25</b>	32	<b>1.25</b>	32	<b>1.25</b>	32	<b>4.00</b>	102
EIS-FR-150-2S	FF-D-0148	<b>1.50</b>	38	<b>0.750</b>	19	<b>2.250</b>	57	<b>1.50</b>	38	<b>1.50</b>	38	<b>1.50</b>	38	<b>4.00</b>	102
EIS-FR-175-2S	FF-D-0148	<b>1.75</b>	44	<b>0.875</b>	22	<b>2.625</b>	67	<b>1.75</b>	44	<b>1.75</b>	44	<b>1.75</b>	44	<b>4.00</b>	102
EIS-FR-200-2S	FF-D-1204	<b>2.00</b>	51	<b>1.000</b>	25	<b>3.000</b>	76	<b>2.00</b>	51	<b>2.00</b>	51	<b>2.00</b>	51	<b>4.00</b>	102
EIS-FR-225-2S	FF-D-1204	<b>2.25</b>	57	<b>1.125</b>	29	<b>3.375</b>	86	<b>2.25</b>	57	<b>2.25</b>	57	<b>2.25</b>	57	<b>4.00</b>	102
EIS-FR-250-2S	FF-D-1204	<b>2.50</b>	64	<b>1.250</b>	32	<b>3.750</b>	95	<b>2.50</b>	64	<b>2.50</b>	64	<b>2.50</b>	64	<b>4.00</b>	102
EIS-FR-275-2S	FF-D-1204	<b>2.75</b>	70	<b>1.375</b>	35	<b>4.125</b>	105	<b>2.75</b>	70	<b>2.75</b>	70	<b>2.75</b>	70	<b>4.00</b>	102
EIS-FR-300-2S	FF-D-1204	<b>3.00</b>	76	<b>1.500</b>	38	<b>4.500</b>	114	<b>3.00</b>	76	<b>3.00</b>	76	<b>3.00</b>	76	<b>4.00</b>	102
EIS-FR-325-2S	FF-D-1206	<b>3.25</b>	83	<b>1.625</b>	41	<b>4.875</b>	124	<b>3.25</b>	83	<b>3.25</b>	83	<b>3.25</b>	83	<b>4.00</b>	102
EIS-FR-350-2S	FF-D-1206	<b>3.50</b>	89	<b>1.750</b>	44	<b>5.250</b>	133	<b>3.50</b>	89	<b>3.50</b>	89	<b>3.50</b>	89	<b>4.00</b>	102
EIS-FR-375-2S	FF-D-1206	<b>3.75</b>	95	<b>1.875</b>	48	<b>5.625</b>	143	<b>3.75</b>	95	<b>3.75</b>	95	<b>3.75</b>	95	<b>4.00</b>	102
EIS-FR-400-2S	FF-D-1206	<b>4.00</b>	102	<b>2.000</b>	51	<b>6.000</b>	152	<b>4.00</b>	102	<b>4.00</b>	102	<b>4.00</b>	102	<b>4.00</b>	102

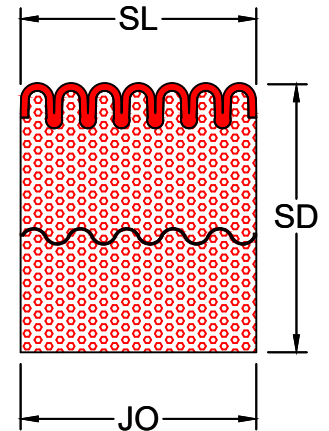

SINGLE SIDE  
SILICONE

Please note that Joint Opening (JO) and Sight Line (SL) are one in the same for the EIS-FR Series.

Double side silicone not required for fire rating, but available for aesthetic purposes.

Cover plates are available as an option to protect the foam seals but are not mandatory for sizes above.

## (EIS-FR-2D) FIRE RATED EXPANSION JOINT MOVEMENT CHART

Model Number	UL Listing	Joint Opening (JO <sup>N</sup> )		Thermal / Seismic Movement (JO <sup>T</sup> )				Total (JO <sup>A</sup> )		Lateral		Vertical		Seal Depth (SD)	
		Nominal		Minimum		Maximum		Movement		Shear		Displacement			
EIS-FR-425-2D	FF-D-1207	<b>4.25</b>	108	<b>2.125</b>	54	<b>6.375</b>	162	<b>4.25</b>	108	<b>4.25</b>	108	<b>4.25</b>	108	<b>4.00</b>	102
EIS-FR-450-2D	FF-D-1207	<b>4.50</b>	114	<b>2.250</b>	57	<b>6.750</b>	178	<b>4.50</b>	114	<b>4.50</b>	114	<b>4.50</b>	114	<b>4.00</b>	102
EIS-FR-475-2D	FF-D-1207	<b>4.75</b>	121	<b>2.375</b>	60	<b>7.125</b>	181	<b>4.75</b>	121	<b>4.75</b>	121	<b>4.75</b>	121	<b>4.00</b>	102
EIS-FR-500-2D	FF-D-1207	<b>5.00</b>	127	<b>2.500</b>	64	<b>7.500</b>	191	<b>5.00</b>	127	<b>5.00</b>	127	<b>5.00</b>	127	<b>4.00</b>	102

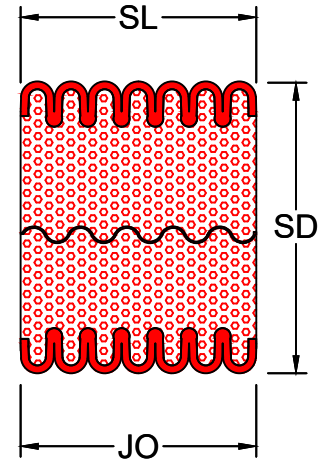

DOUBLE SIDE  
SILICONE

Dimension shown in **inches** (bold) and millimeters. Contact MM Systems for larger system sizes.

Double side silicone required to achieve fire rating for sizes above.

Cover plate required for 4.25 inch and larger.

**Refer to the EIS-FR-2 AutoCAD file for individual seal drawings.**



50 MM WAY  
PENDERGRASS, GA. 30567  
706-824-7500 PHONE

[www.mm.systems](http://www.mm.systems)

For Spec-Data, Install Guides, and other data visit [www.mm.systems](http://www.mm.systems)

### RIGHTS OF DESIGN

All rights of design, detail, engineering and/or invention contained herein are the property of MM Systems and hereby reserved and are not to be reproduced or provided to any other party. MM Systems reserves the right to amend or withdraw any information contained herein without notice and will not be liable for any inaccuracy or ambiguity of said information.

### Expanding Impregnated Seal - 2 Hour Fire Rated Expansion Joint

## EIS-FR-2S & EIS-FR-2D Series

Drawn by:

LRM

Scale:

NTS

Drawing Number:

SHT. 3 OF 3

Issue Date:

01/07/2025

31652-01